



January 25, 2024

To: Stephanie James Metro Water Services

Re: **Eaton Creek Commons Phase 2
Planning Commission Mandatory Referral 2024M-010ES-001
Council District #01 Joy Kimbrough, Council Member**

On behalf of the Metropolitan Planning Commission, the following item, referred to the Commission as required by the Metro Charter, has been recommended for *approval* to the Metropolitan Council:

A request for the abandonment 771 linear feet of eight-inch water main (CIP) and acceptance of approximately 1,601 linear feet of eight-inch water main (DIP), one fire hydrant assembly and 391 linear feet of 8 inch sewer main (PVC), two sanitary sewer manholes, and the replacement of one fire hydrant assembly and any associated easements to serve the Eaton Creek Commons Phase 2 development.

The relevant Metro agencies (Metro Parks, Metro Public Works, Metro Water Services, Metro Emergency Communications, the Nashville Electric Service, Metro Finance – Public Property and the Metro Historical Commission) have reviewed the proposal and concur in the recommendation for approval. This request must be approved by the Metro Council to become effective. A sketch showing the location of the request is attached to this letter.

Conditions that apply to this approval: none

This recommendation for approval is given as set forth in the Metropolitan Planning Commission Rules and Procedures. If you have any questions about this matter, please contact Delilah Rhodes at Delilah.Rhodes@nashville.gov or 615-862-7208

Sincerely,

A handwritten signature in blue ink that reads "Lisa Milligan".

Lisa Milligan
Assistant Director Land Development
Metro Planning Department
cc: *Metro Clerk*

**Re: Eaton Creek Commons Phase 2
Planning Commission Mandatory Referral 2024M-010ES-001
Council District #01 Joy Kimbrough, Council Member**

A request for the abandonment 771 linear feet of eight-inch water main (CIP) and acceptance of approximately 1,601 linear feet of eight-inch water main (DIP), one fire hydrant assembly and 391 linear feet of 8-inch sewer main (PVC), two sanitary sewer manholes, and the replacement of one fire hydrant assembly and any associated easements to serve the Eaton Creek Commons Phase 2 development.

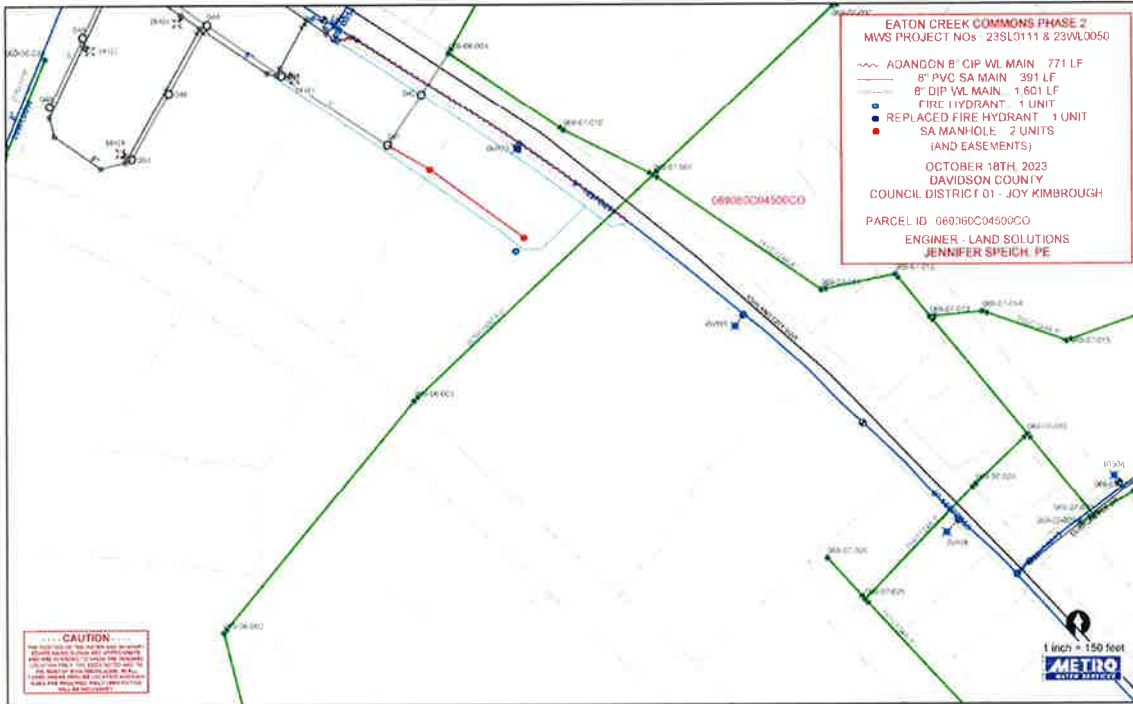

EATON CREEK COMMONS PHASE 2
MWS PROJECT NOS.: 23SL0111 & 23WL0050

- ~ ADANDON 8" CIP WL MAIN... 771 LF
- 8" PVC SA MAIN... 391 LF
- 8" DIP WL MAIN... 1,601 LF
- FIRE HYDRANT... 1 UNIT
- REPLACED FIRE HYDRANT... 1 UNIT
- SA MANHOLE... 2 UNITS (AND EASEMENTS)

OCTOBER 18TH, 2023
 DAVIDSON COUNTY
 COUNCIL DISTRICT 01 - JOY KIMBROUGH

PARCEL ID: 069060C04500CO
 ENGINEER - LAND SOLUTIONS
 JENNIFER SPEICH, PE

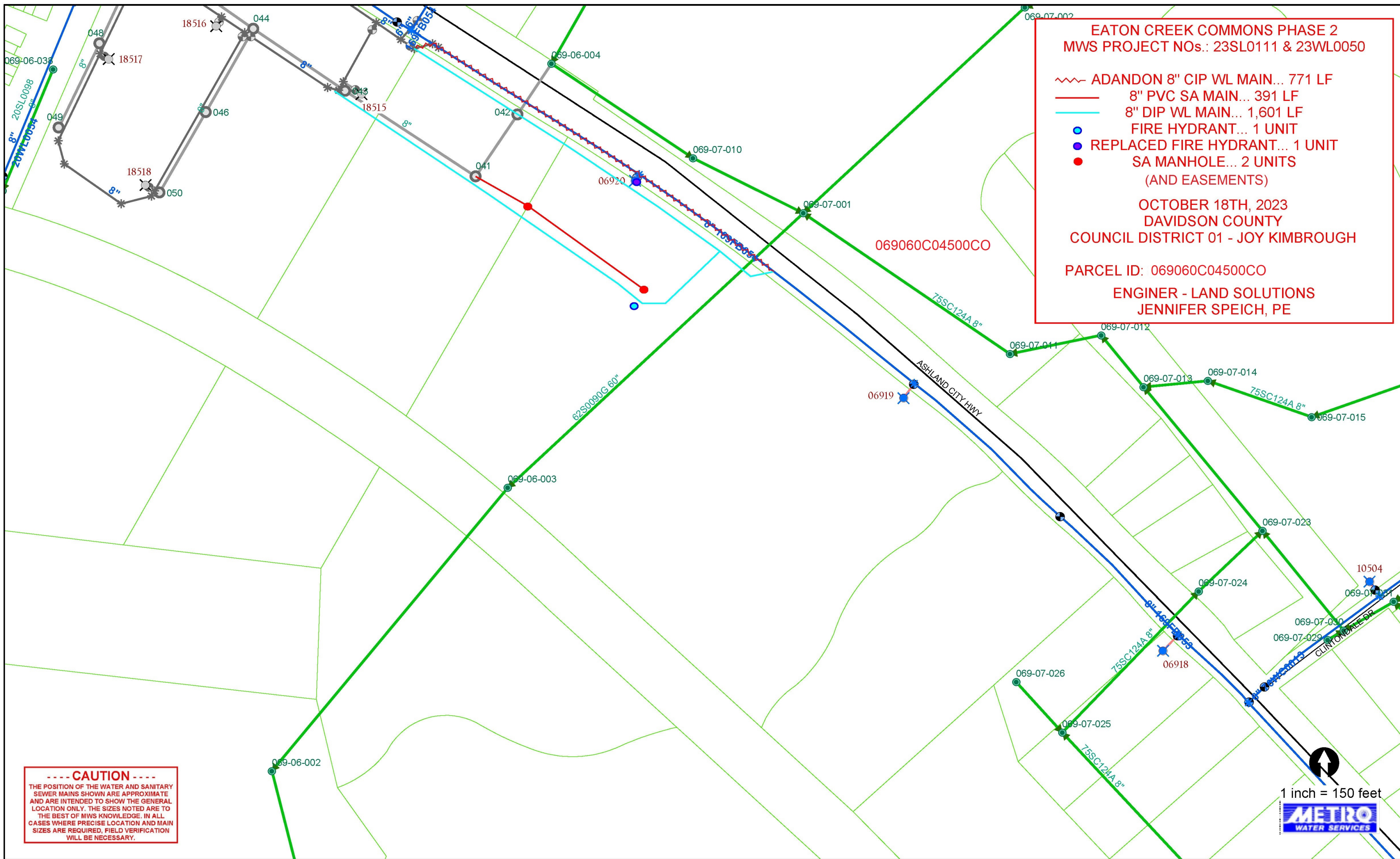

----- CAUTION -----
 THE POSITION OF THE WATER AND SANITARY SEWER MAINS SHOWN ARE APPROXIMATE AND ARE INTENDED TO SHOW THE GENERAL LOCATION ONLY. THE SIZES NOTED ARE TO THE BEST OF MWS KNOWLEDGE. IN ALL CASES WHERE PRECISE LOCATION AND MAIN SIZES ARE REQUIRED, FIELD VERIFICATION WILL BE NECESSARY.

1 inch = 150 feet