

Alta Rochelle
 MWS Project No: 23SL0273

Abandon 10" UNK Sewer Main... 60 LF
 Abandon Sewer Manhole... 1 Unit
 Install Sewer Manhole... 1 Unit

December 5th, 2023
 Davidson County
 Council District #17
 Terry Vo

Parcel ID... 10501049400

Engineer... Kimley Horn
 John Richard Patterson, PE

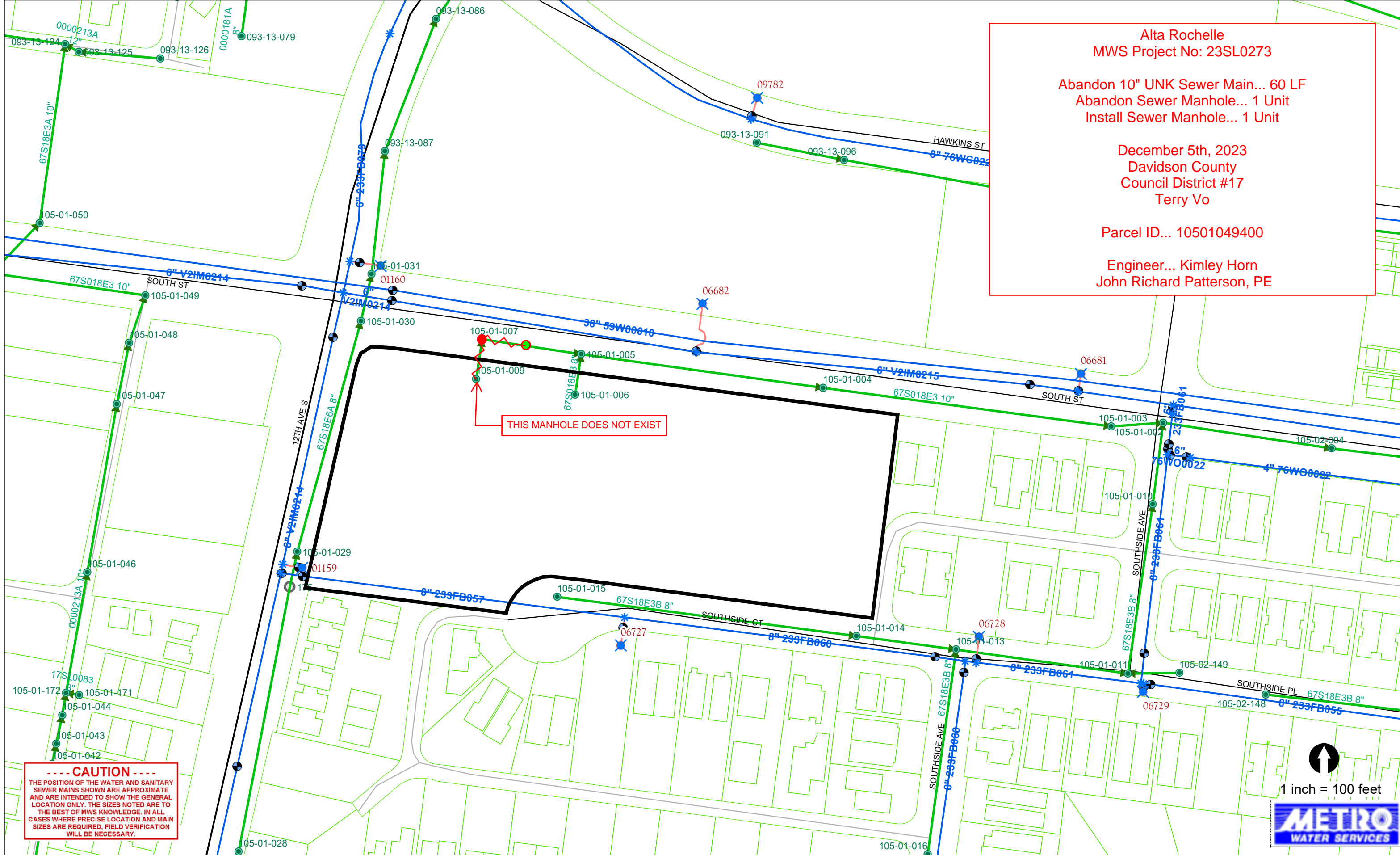

----- CAUTION -----
 THE POSITION OF THE WATER AND SANITARY SEWER MAINS SHOWN ARE APPROXIMATE AND ARE INTENDED TO SHOW THE GENERAL LOCATION ONLY. THE SIZES NOTED ARE TO THE BEST OF MWS KNOWLEDGE. IN ALL CASES WHERE PRECISE LOCATION AND MAIN SIZES ARE REQUIRED, FIELD VERIFICATION WILL BE NECESSARY.

1 inch = 100 feet
 METRO WATER SERVICES



January 03, 2024

To: Mike Atchison Metro Water Services

Re: **Alta Rochelle**
Planning Commission Mandatory Referral 2023M-210ES-001
Council District #17 Terry Vo, Council Member

On behalf of the Metropolitan Planning Commission, the following item, referred to the Commission as required by the Metro Charter, has been recommended for *approval* to the Metropolitan Council:

A request for the abandonment of approximately 60 linear feet of 10-inch sanitary sewer main and one sanitary sewer manhole, and the acceptance of one new sanitary sewer manhole to serve the Alta Rochelle development.

The relevant Metro agencies (Metro Parks, Metro Public Works, Metro Water Services, Metro Emergency Communications, the Nashville Electric Service, Metro Finance – Public Property and the Metro Historical Commission) have reviewed the proposal and concur in the recommendation for approval. This request must be approved by the Metro Council to become effective. A sketch showing the location of the request is attached to this letter.

Conditions that apply to this approval: none

This recommendation for approval is given as set forth in the Metropolitan Planning Commission Rules and Procedures. If you have any questions about this matter, please contact Delilah Rhodes at Delilah.Rhodes@nashville.gov or 615-862-7208

Sincerely,

A handwritten signature in blue ink that reads "Lisa Milligan".

Lisa Milligan
Assistant Director Land Development
Metro Planning Department
cc: *Metro Clerk*

**Re: Alta Rochelle
Planning Commission Mandatory Referral 2023M-210ES-001
Council District #17 Terry Vo, Council Member**

A request for the abandonment of approximately 60 linear feet of 10-inch sanitary sewer main and one sanitary sewer manhole, and the acceptance of one new sanitary sewer manhole to serve the Alta Rochelle development.

