



May 17, 2024

To: Mike Atchison Metro Water Services

Re: **103 Fern Avenue**  
**Planning Commission Mandatory Referral 2024M-066ES-001**  
**Council District #02 Kyonzte Toombs, Council Member**

On behalf of the Metropolitan Planning Commission, the following item, referred to the Commission as required by the Metro Charter, has been recommended for *approval* to the Metropolitan Council:

*A request for the acceptance of approximately 163 linear feet of eight-inch sanitary sewer main (DIP), two sanitary sewer manholes, and easement to serve the development at 103 Fern Avenue.*

The relevant Metro agencies (Metro Parks, Nashville Department of Transportation, Metro Water Services, Metro Emergency Communications, the Nashville Electric Service, Metro Finance – Public Property and the Metro Historical Commission) have reviewed the proposal and concur in the recommendation for approval. This request must be approved by the Metro Council to become effective. A sketch showing the location of the request is attached to this letter.

**Conditions that apply to this approval: none**

This recommendation for approval is given as set forth in the Metropolitan Planning Commission Rules and Procedures. If you have any questions about this matter, please contact Delilah Rhodes at [Delilah.Rhodes@nashville.gov](mailto:Delilah.Rhodes@nashville.gov) or 615-862-7208

Sincerely,

A handwritten signature in blue ink that reads "Lisa Milligan". The signature is written in a cursive, flowing style.



Lisa Milligan  
Assistant Director Land Development  
Metro Planning Department  
cc: *Metro Clerk*

**Re: 103 Fern Avenue  
Planning Commission Mandatory Referral 2024M-066ES-001  
Council District #02 Kyonzte Toombs, Council Member**

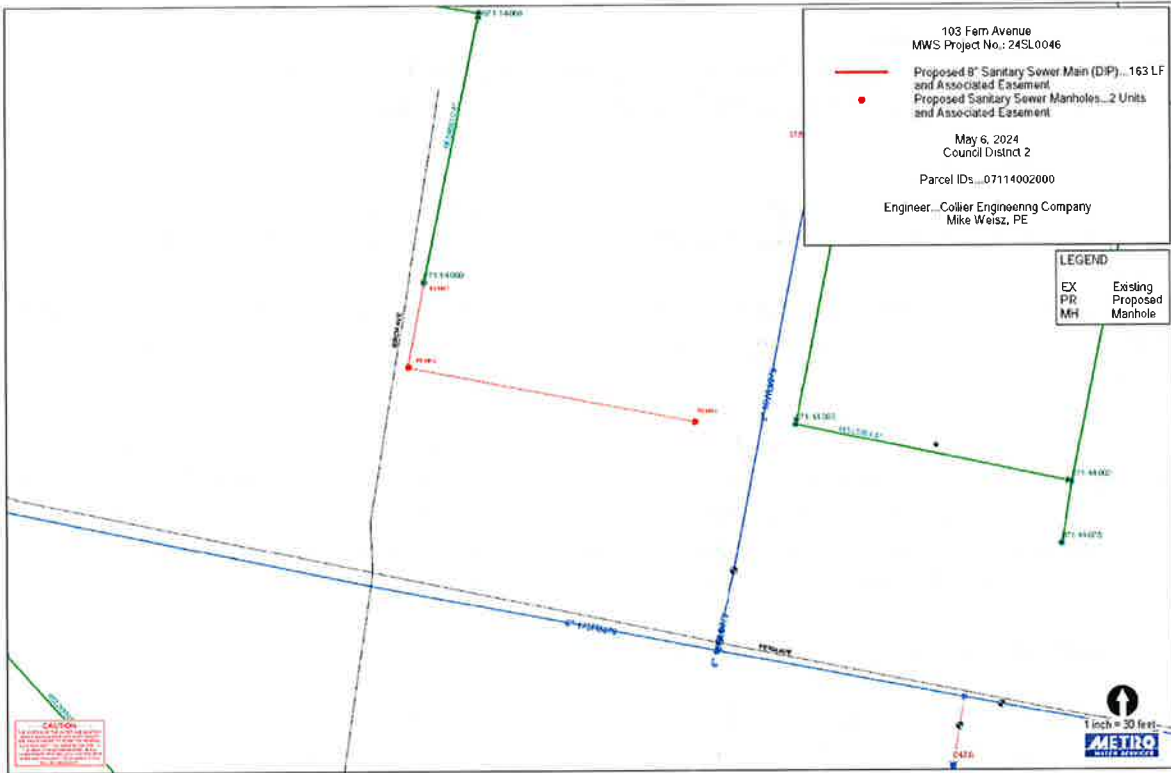
*A request for the acceptance of approximately 163 linear feet of eight-inch sanitary sewer main (DIP), two sanitary sewer manholes, and easement to serve the development at 103 Fern Avenue.*



103 Fern Avenue  
MWS Project No.: 24SL0046

-  Proposed 8" Sanitary Sewer Main (DIP)...163 LF and Associated Easement
-  Proposed Sanitary Sewer Manholes...2 Units and Associated Easement

May 6, 2024  
Council District 2

Parcel IDs...07114002000

Engineer...Collier Engineering Company  
Mike Weisz, PE

LEGEND	
EX	Existing
PR	Proposed
MH	Manhole

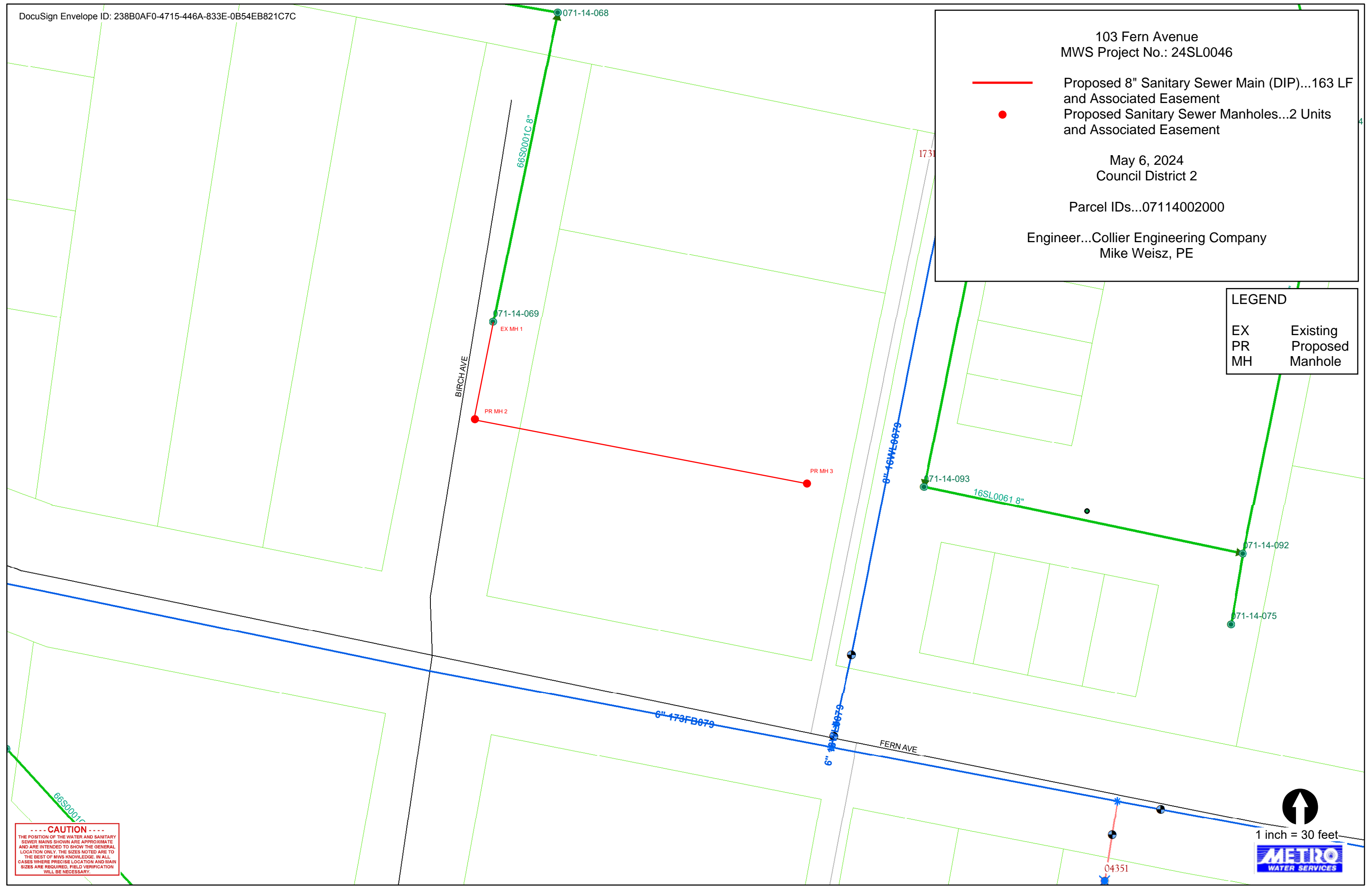

**----- CAUTION -----**  
 THE POSITION OF THE WATER AND SANITARY SEWER MAINS SHOWN ARE APPROXIMATE AND ARE INTENDED TO SHOW THE GENERAL LOCATION ONLY. THE SIZES NOTED ARE TO THE BEST OF MWS KNOWLEDGE. IN ALL CASES WHERE PRECISE LOCATION AND MAIN SIZES ARE REQUIRED, FIELD VERIFICATION WILL BE NECESSARY.

1 inch = 30 feet

