



**METROPOLITAN GOVERNMENT OF NASHVILLE
AND DAVIDSON COUNTY**
Metro Office Building
800 President Ronald Reagan Way
P.O. Box 196300
Nashville, TN 37219-6300

October 4, 2022

To: Edward Thurman, Metro Water Services

**Re: CAYCE UTILITIES PHASE 1B
Planning Commission Mandatory Referral #2022M-144ES-001
Council District #06 Brett Withers, Council Member**

On behalf of the Metropolitan Planning Commission, the following item, referred to the Commission as required by the Metro Charter, has been recommended for *approval* to the Metropolitan Council:

A request for the abandonment of approximately 1,340 linear feet of 6-inch water main, 429 linear feet of 8-inch water main, 401 linear feet of 8-inch sanitary sewer main, a sanitary sewer manhole and easements, the replacement of one sanitary sewer manhole, and the acceptance of approximately 1,660 linear feet of 8-inch water main (DIP), 404 linear feet of 8-inch sanitary sewer main (PVC), one fire hydrant assembly, two sanitary sewer manholes, and easements to serve the Cayce Utilities Phase 1B development.

The relevant Metro agencies (Metro Parks, Metro Public Works, Metro Water Services, Metro Emergency Communications, the Nashville Electric Service, Metro Finance – Public Property and the Metro Historical Commission) have reviewed the proposal and concur in the recommendation for approval. This request must be approved by the Metro Council to become effective. A sketch showing the location of the request is attached to this letter.

Conditions that apply to this approval: none

This recommendation for approval is given as set forth in the Metropolitan Planning Commission Rules and Procedures. If you have any questions about this matter, please contact Delilah Rhodes at delilah.rhodes@nashville.gov or 615-862-7208.

Sincerely,

A handwritten signature in blue ink, appearing to read 'Lisa Milligan'.

Lisa Milligan
Land Development Manager
Metro Planning Department
cc: Metro Clerk

Re: CAYCE UTILITIES PHASE 1B
Planning Commission Mandatory Referral #2022M-144ES-001
Council District #06 Brett Withers, Council Member



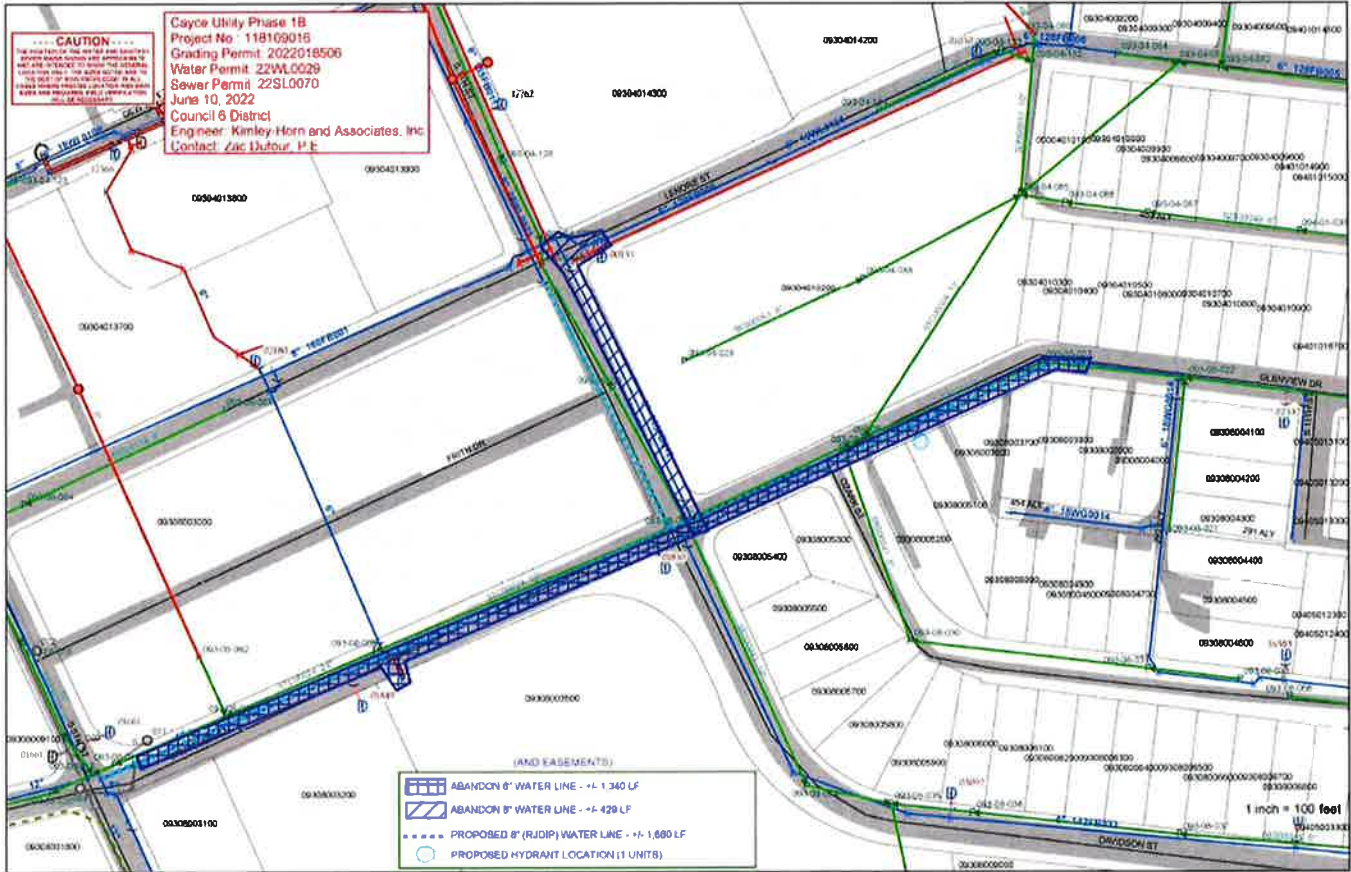

A request for the abandonment of approximately 1,340 linear feet of 6-inch water main, 429 linear feet of 8-inch water main, 401 linear feet of 8-inch sanitary sewer main, a sanitary sewer manhole and easements, the replacement of one sanitary sewer manhole, and the acceptance of approximately 1,660 linear feet of 8-inch water main (DIP), 404 linear feet of 8-inch sanitary sewer main (PVC), one fire hydrant assembly, two sanitary sewer manholes, and easements to serve the Cayce Utilities Phase 1B development.

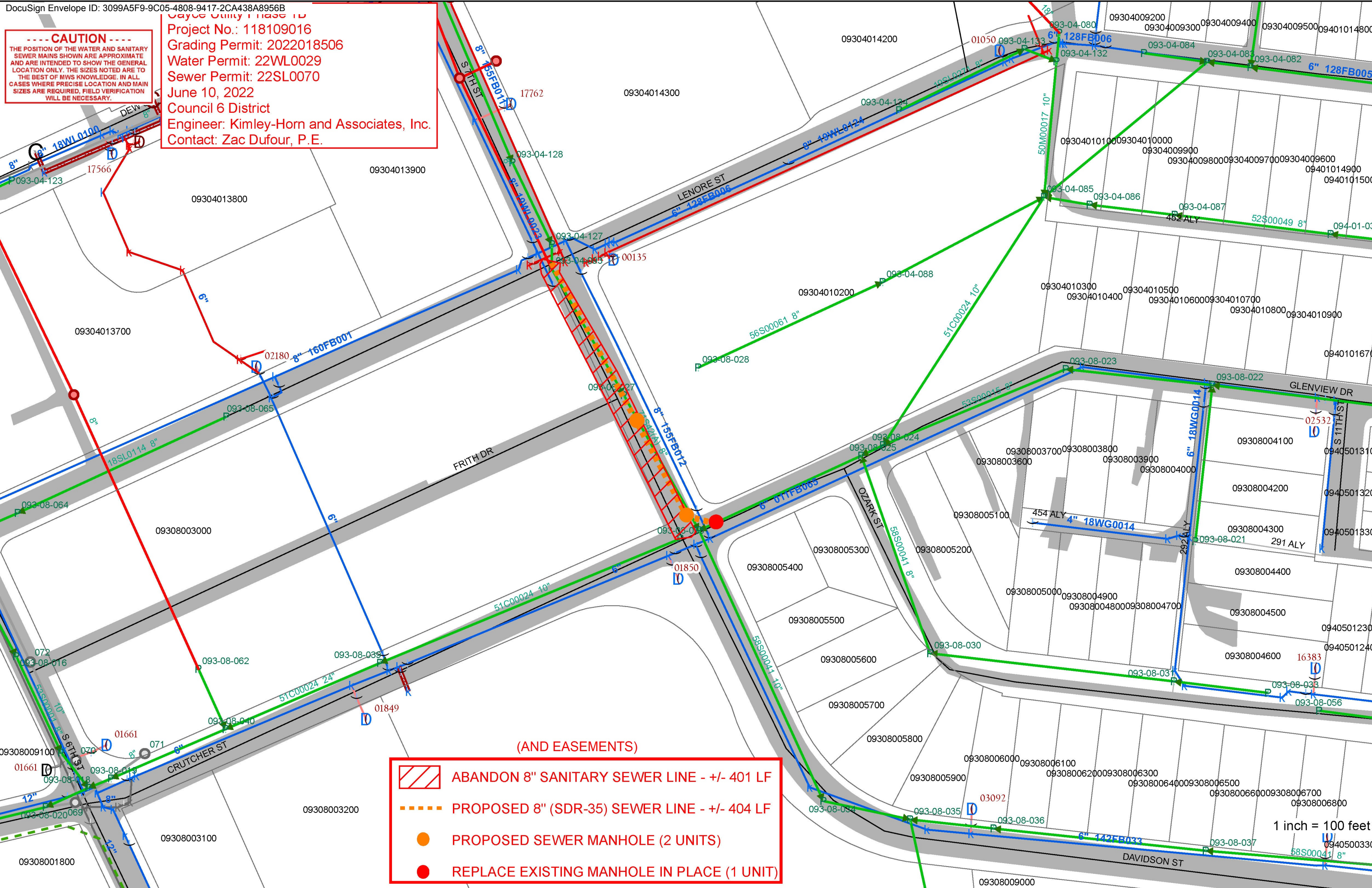

Cayce Utility Phase 1B
Project No.: 118109016
Grading Permit: 2022018506
Water Permit: 22WL0029
Sewer Permit: 22SL0070
June 10, 2022
Council 6 District
Engineer: Kimley-Horn and Associates, Inc.
Contact: Zac Dufour, P.E.

----- CAUTION -----
THE POSITION OF THE WATER AND SANITARY SEWER MAINS SHOWN ARE APPROXIMATE AND ARE INTENDED TO SHOW THE GENERAL LOCATION ONLY. THE SIZES NOTED ARE TO THE BEST OF MWS KNOWLEDGE. IN ALL CASES WHERE PRECISE LOCATION AND MAIN SIZES ARE REQUIRED, FIELD VERIFICATION WILL BE NECESSARY.



- (AND EASEMENTS)
-  ABANDON 8" SANITARY SEWER LINE - +/- 401 LF
 -  PROPOSED 8" (SDR-35) SEWER LINE - +/- 404 LF
 -  PROPOSED SEWER MANHOLE (2 UNITS)
 -  REPLACE EXISTING MANHOLE IN PLACE (1 UNIT)



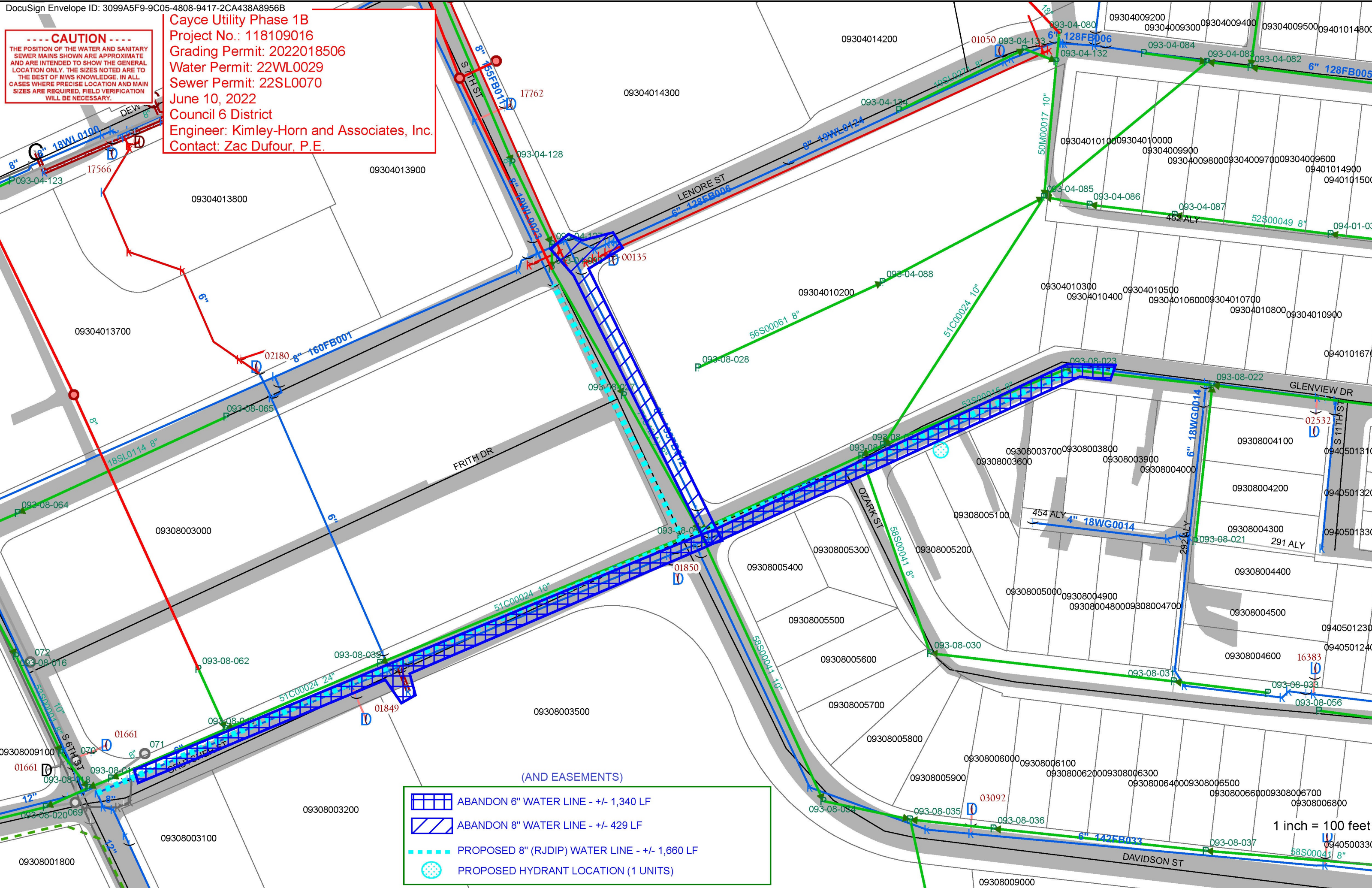

1 inch = 100 feet

Cayce Utility Phase 1B
Project No.: 118109016
Grading Permit: 2022018506
Water Permit: 22WL0029
Sewer Permit: 22SL0070
June 10, 2022
Council 6 District
Engineer: Kimley-Horn and Associates, Inc.
Contact: Zac Dufour, P.E.

----- CAUTION -----
 THE POSITION OF THE WATER AND SANITARY SEWER MAINS SHOWN ARE APPROXIMATE AND ARE INTENDED TO SHOW THE GENERAL LOCATION ONLY. THE SIZES NOTED ARE TO THE BEST OF MWS KNOWLEDGE. IN ALL CASES WHERE PRECISE LOCATION AND MAIN SIZES ARE REQUIRED, FIELD VERIFICATION WILL BE NECESSARY.

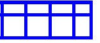

(AND EASEMENTS)

	ABANDON 6" WATER LINE - +/- 1,340 LF
	ABANDON 8" WATER LINE - +/- 429 LF
	PROPOSED 8" (RJDIP) WATER LINE - +/- 1,660 LF
	PROPOSED HYDRANT LOCATION (1 UNITS)

1 inch = 100 feet