



**METROPOLITAN GOVERNMENT OF NASHVILLE  
AND DAVIDSON COUNTY**

Metro Office Building  
800 President Ronald Reagan Way  
P.O. Box 196300  
Nashville, TN 37219-6300

February 2, 2023

To: Stephanie James Metro Water Services

**Re: FOX VALLEY SUBDIVISION PHASE 3  
Planning Commission Mandatory Referral # 2023M-010ES-001  
Council District #09 Tonya Hancock, Council Member**

On behalf of the Metropolitan Planning Commission, the following item, referred to the Commission as required by the Metro Charter, has been recommended for *approval* to the Metropolitan Council:

*A request for the acceptance of approximately 1,151 linear feet of eight-inch sanitary sewer main (PVC), six sanitary sewer manholes, and any associated easements to serve the Fox Valley Phase 3 development.*

The relevant Metro agencies (Metro Parks, Metro Public Works, Metro Water Services, Metro Emergency Communications, the Nashville Electric Service, Metro Finance – Public Property and the Metro Historical Commission) have reviewed the proposal and concur in the recommendation for approval. This request must be approved by the Metro Council to become effective. A sketch showing the location of the request is attached to this letter.

**Conditions that apply to this approval: none**

This recommendation for approval is given as set forth in the Metropolitan Planning Commission Rules and Procedures. If you have any questions about this matter, please contact Delilah Rhodes at [delilah.rhodes@nashville.gov](mailto:delilah.rhodes@nashville.gov) or 615-862-7208.

Sincerely,

A handwritten signature in blue ink that reads "Lisa Milligan".

Lisa Milligan  
Land Development Manager  
Metro Planning Department  
cc: *Metro Clerk*

**Re: FOX VALLEY SUBDIVISION PHASE 3**  
**Planning Commission Mandatory Referral # 2023M-010ES-001**  
**Council District #09 Tonya Hancock, Council Member**

*A request for the acceptance of approximately 1,151 linear feet of eight-inch sanitary sewer main (PVC), six sanitary sewer manholes, and any associated easements to serve the Fox Valley Phase 3 development.*

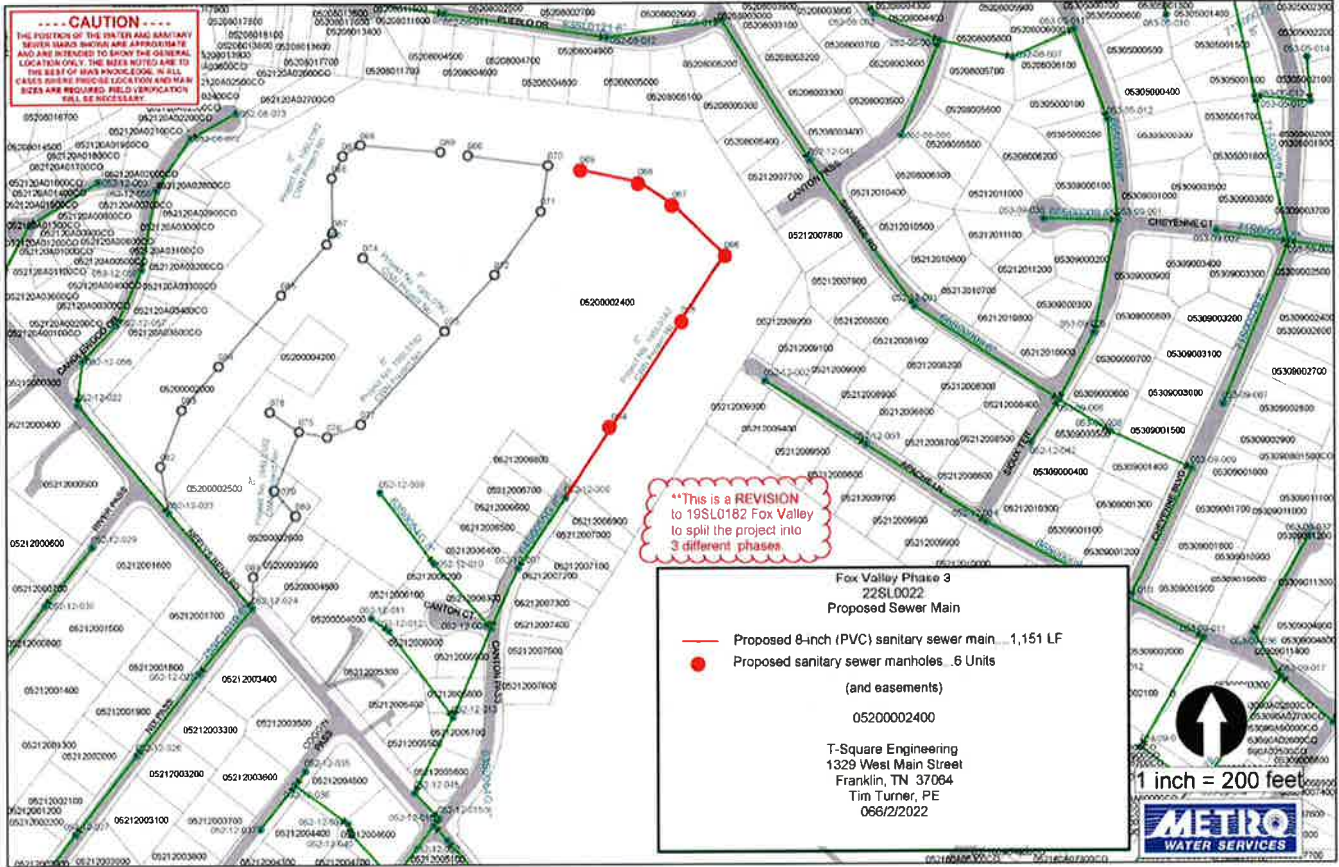

**----- CAUTION -----**  
THE POSITION OF THE WATER AND SANITARY SEWER MAINS SHOWN ARE APPROXIMATE AND ARE INTENDED TO SHOW THE GENERAL LOCATION ONLY. THE SIZES NOTED ARE TO THE BEST OF MWS KNOWLEDGE. IN ALL CASES WHERE PRECISE LOCATION AND MAIN SIZES ARE REQUIRED, FIELD VERIFICATION WILL BE NECESSARY.

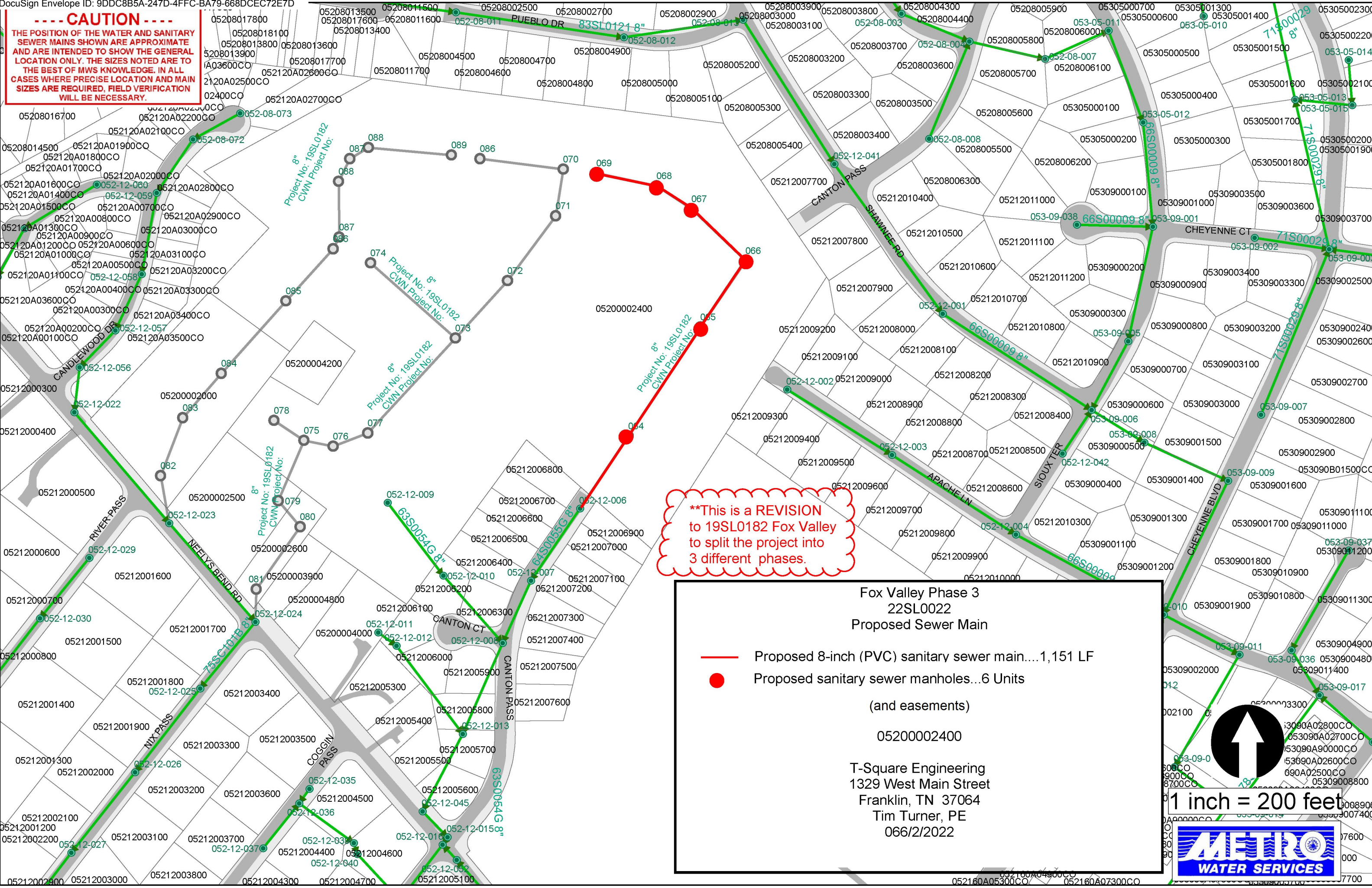

**\*\*This is a REVISION to 19SL0182 Fox Valley to split the project into 3 different phases.**

**Fox Valley Phase 3**  
22SL0022  
Proposed Sewer Main

- Proposed 8-inch (PVC) sanitary sewer main...1,151 LF
- Proposed sanitary sewer manholes...6 Units (and easements)

0520002400

T-Square Engineering  
1329 West Main Street  
Franklin, TN 37064  
Tim Turner, PE  
066/2/2022

1 inch = 200 feet