

**502 THOMPSON LANE DEVELOPMENT  
PROJECT NO. 21-SL-267  
Parcel List**

<b><u>Address</u></b>	<b><u>Map/Parcels</u></b>	<b><u>Property Owners</u></b>
520 Thompson Lane	11909009300	502 Thompson Lane, LLC
518 Thompson Lane	11909009400	502 Thompson Lane, LLC
514 Thompson Lane	11909009500	502 Thompson Lane, LLC
512 Thompson Lane	11909009600	502 Thompson Lane, LLC
510 Thompson Lane	11909009700	502 Thompson Lane, LLC
508 Thompson Lane	11909009800	502 Thompson Lane, LLC
504 Thompson Lane	11909009900	502 Thompson Lane, LLC
2807 Grandview Avenue	11909010300	502 Thompson Lane, LLC



**METROPOLITAN GOVERNMENT OF NASHVILLE  
AND DAVIDSON COUNTY**  
Metro Office Building  
800 President Ronald Reagan Way  
P.O. Box 196300  
Nashville, TN 37219-6300

July 21, 2023

To: Edward Thurman Metro Water Services

**Re: 502 THOMPSON LANE DEVELOPMENT  
Planning Commission Mandatory Referral 2023M-115ES-001  
Council District #16 Ginny Welsch, Council Member**

On behalf of the Metropolitan Planning Commission, the following item, referred to the Commission as required by the Metro Charter, has been recommended for *approval* to the Metropolitan Council:

*A request for the abandonment of approximately 789 linear feet of 8-inch sanitary sewer main (UKN), 22 linear feet of 8-inch sanitary sewer main (RCP), four sanitary sewer manholes and easements and the acceptance of approximately 652 linear feet linear feet of 8-inch sanitary sewer main (PVC), 106 linear feet of 10-inch sanitary sewer main (PVC), four sanitary sewer manholes and easements to serve the development at 502 Thompson Lane.*

The relevant Metro agencies (Metro Parks, Metro Public Works, Metro Water Services, Metro Emergency Communications, the Nashville Electric Service, Metro Finance – Public Property and the Metro Historical Commission) have reviewed the proposal and concur in the recommendation for approval. This request must be approved by the Metro Council to become effective. A sketch showing the location of the request is attached to this letter.

**Conditions that apply to this approval: none**

This recommendation for approval is given as set forth in the Metropolitan Planning Commission Rules and Procedures. If you have any questions about this matter, please contact Delilah Rhodes at [delilah.rhodes@nashville.gov](mailto:delilah.rhodes@nashville.gov) or 615-862-7208.

Sincerely,

A handwritten signature in blue ink that reads "Lisa Milligan".





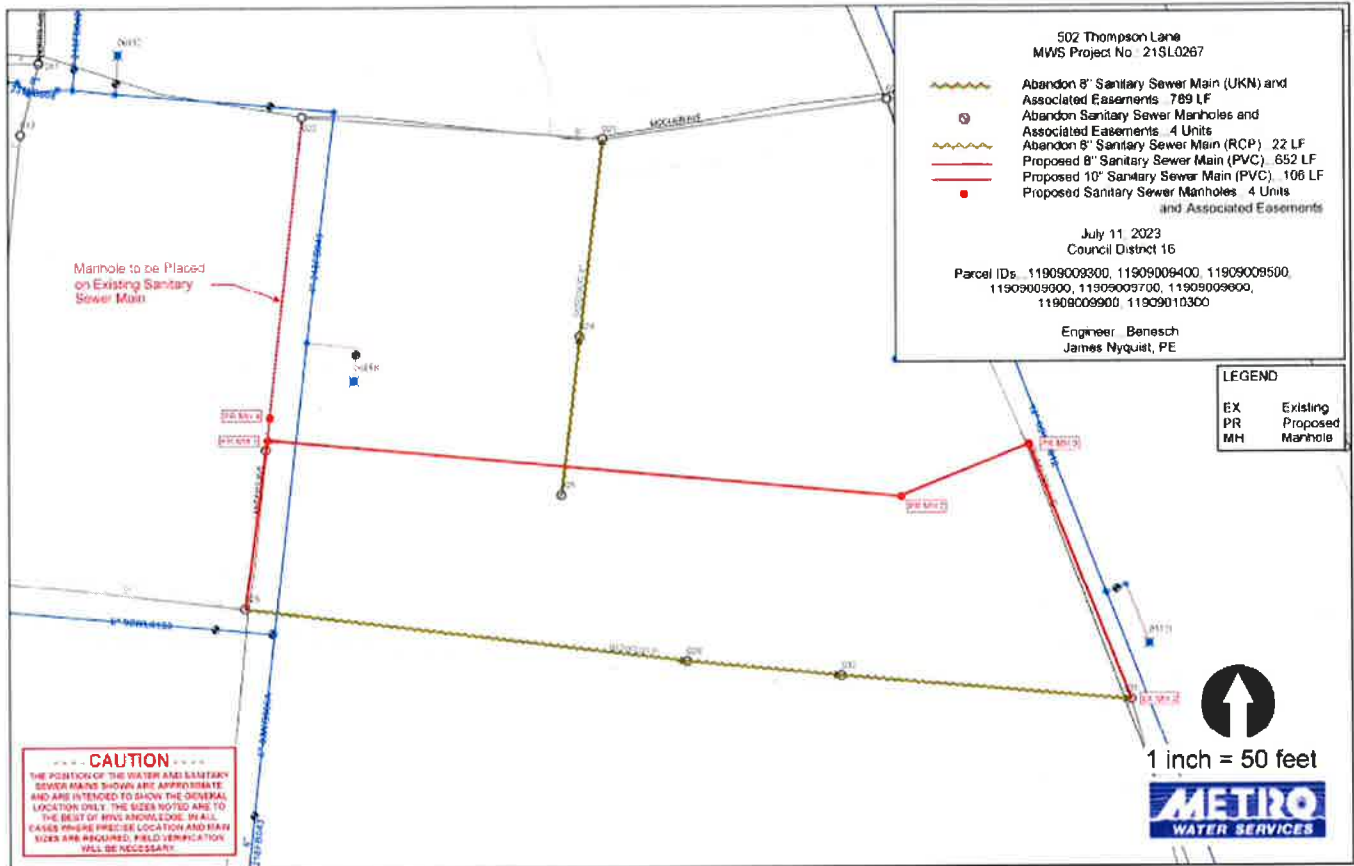

Lisa Milligan  
Land Development Manager  
Metro Planning Department  
cc: Metro Clerk

**Re: 502 THOMPSON LANE DEVELOPMENT**  
**Planning Commission Mandatory Referral # 2023M-115ES-001**  
**Council District #16 Ginny Welsch, Council Member**

*A request for the abandonment of approximately 789 linear feet of 8-inch sanitary sewer main (UKN), 22 linear feet of 8-inch sanitary sewer main (RCP), four sanitary sewer manholes and easements and the acceptance of approximately 652 linear feet of 8-inch sanitary sewer main (PVC), 106 linear feet of 10-inch sanitary sewer main (PVC), four sanitary sewer manholes and easements to serve the development at 502 Thompson Lane.*



502 Thompson Lane  
MWS Project No.: 21SL0267

-  Abandon 8" Sanitary Sewer Main (UKN) and Associated Easements...789 LF
-  Abandon Sanitary Sewer Manholes and Associated Easements...4 Units
-  Abandon 8" Sanitary Sewer Main (RCP)...22 LF
-  Proposed 8" Sanitary Sewer Main (PVC)...652 LF
-  Proposed 10" Sanitary Sewer Main (PVC)...106 LF
-  Proposed Sanitary Sewer Manholes...4 Units and Associated Easements

July 11, 2023  
Council District 16

Parcel IDs...11909009300, 11909009400, 11909009500,  
11909009600, 11909009700, 11909009800,  
11909009900, 11909010300

Engineer...Benesch  
James Nyquist, PE

LEGEND	
EX	Existing
PR	Proposed
MH	Manhole

Manhole to be Placed  
on Existing Sanitary  
Sewer Main

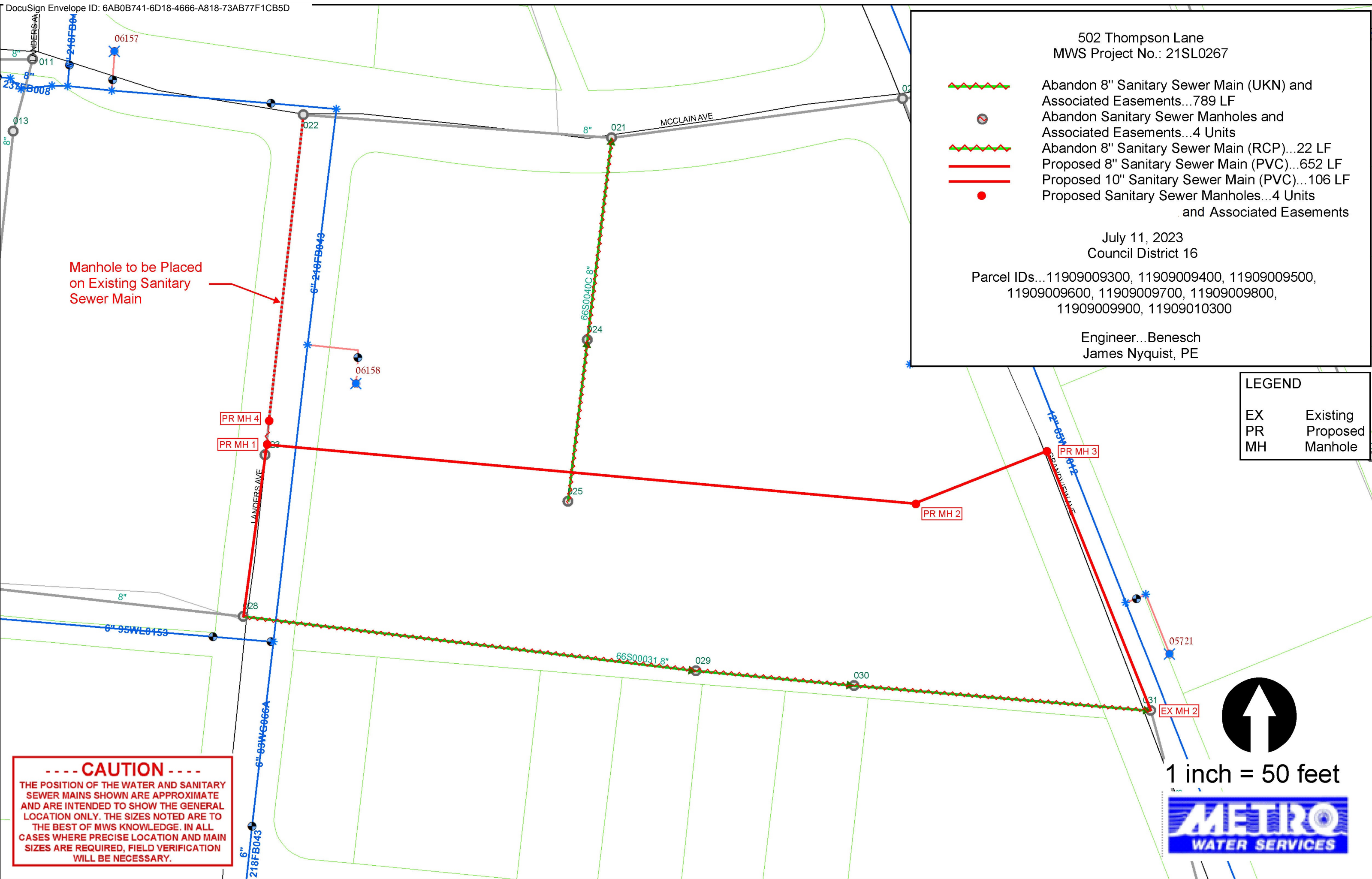

**----- CAUTION -----**  
 THE POSITION OF THE WATER AND SANITARY SEWER MAINS SHOWN ARE APPROXIMATE AND ARE INTENDED TO SHOW THE GENERAL LOCATION ONLY. THE SIZES NOTED ARE TO THE BEST OF MWS KNOWLEDGE. IN ALL CASES WHERE PRECISE LOCATION AND MAIN SIZES ARE REQUIRED, FIELD VERIFICATION WILL BE NECESSARY.

1 inch = 50 feet

